

DETEX
ESCORT
BY **GCS**



**Life Safety,
Security and
Security Assurance**

ARCHITECTURAL
HARDWARE

LOSS PREVENTION
PRODUCTS

ACCESS
CONTROL

SYSTEM
ENHANCEMENTS

INTEGRATED
SYSTEMS

**GUARD TOUR
VERIFICATION**

**Trust Detex to provide
the industry standard for
reliable Guard Tour Verification**

Where Trust is Built™
DETEX
Guard Tour Verification

In today's corporate environment, sophisticated data collection and auto-ID systems are more important than ever. Data collection systems require check points that are unique, manipulation-proof and absolutely reliable. Patrol Manager gives you all this - and more! The Detex Patrol Manager offers state-of-the-art electronic equipment to help you monitor and control your security, safety and maintenance requirement.

All of our systems are easy to use, yet highly sophisticated.

An environment free of dirt, water, grease, paint and sunlight...? This ideal surrounding rarely exists. The Patrol Manager utilizes a unique magnetizable coded data strip that works effectively and accurately in the real world.



DATA ACQUISITION

All Patrol Manager equipment has been designed and tested to stand up to use (and abuse) in the harshest of conditions. The ESCORTE Data Acquisition Unit (DAU) is solid, lightweight, easy to handle and operate. The electronics in the unit have been sealed in silicon, making it completely waterproof and shock resistant. The unit casing is composed of glass fibre fortified polyester, the same type that is used for motorcycle helmets. There are no confusing buttons to press, nothing to break off or jam. Best of all - the unit needs no recharging. Running on an internal power pack, the DAU can be used 24 hours a day without the need to recharge the unit.

Using the ESCORTE is easy - simply scan the reading head over the data strip and you will get a visual and acoustic confirmation that the information has been stored in the memory of the DAU.

APPLICATIONS

The Escorte System offers a wide range of applications that enables controlling and tracking in a variety of fields, such as guard service, maintenance, asset and inventory as well as work and material management, mass transportation, plus many more...

By simply assigning the data strips to any object, you will obtain immediate reports indicating exactly what has been checked, which day, what time, and status of the object.



DATA STRIPS

Our Data Strips (check points) are designed for indoor and outdoor use. They are completely manipulation-free, and cannot be copied or duplicated in any way. Our data strips have been permanently etched with a unique 8-digit code which allows literally 100 million different control point codes. Data reading is not affected by dirt, soot, extreme temperatures, or humidity. Unlike with traditional paper or plastic bar codes, data transfer is possible even through thin layers of paint or other harsh conditions. Our data strips are small enough to be located almost anywhere; simply mount them with double-sided adhesive, epoxy or security screws. We offer a variety of colored data strips, which makes it easy to blend them into their surrounding environment, and to use colors for defining different data groups.



THE ESCORTE SYSTEM PROVIDES TWO BASIC MODES OF OPERATION

The Patrol Manager Mode

A remarkably easy-to-use system that requires no computer programming or prior computer experience. Via the Data Transfer Unit (DTU), the DAU downloads and prints the report directly to a printer; no computer is required.

The Software Mode

Linking the DAU to a computer-based system provides an ideal solution for evaluating stored data. **DETEX** offers software for a variety of applications such as guarding and maintenance.

TopGuard Patrol & Patrol PLUS Software

TopGuard Patrol offers one comprehensive report format and allows up to 1,750 data points to be programmed as incidents, personnel or control points in up to 16 tours. **TopGuard Patrol PLUS** includes 8 different report formats and allows up to 7,500 data points and 250 rounds; it also includes additional features, such as the ability to create maps of tours using imported JPG or BMP images.

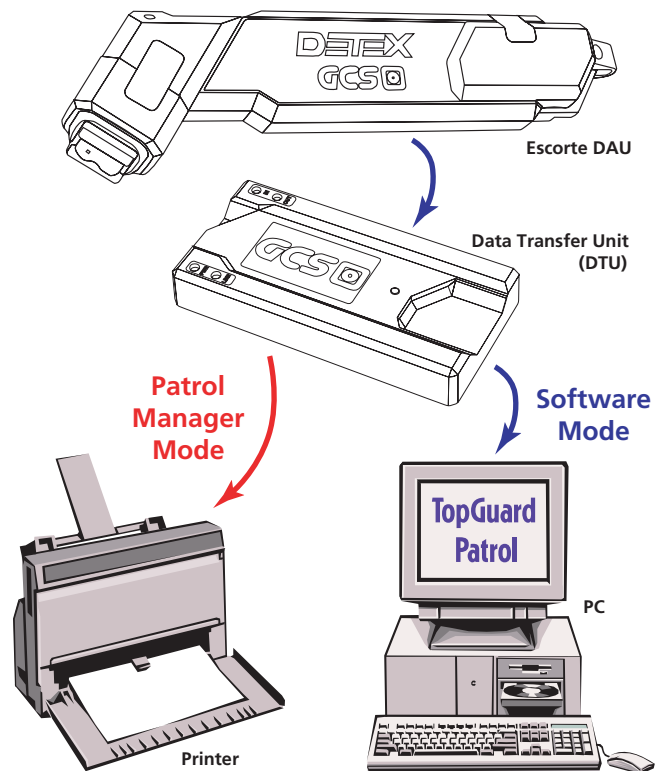

ESCORTE DATA ACQUISITION UNIT



Simply pass the reading head over the Data Strip and you get both an audible and a visible confirmation that the information has been stored in the DAU's memory. The DAU uses alkaline batteries in a silicon-filled power pack.

Data Acquisition Unit Features:

- Waterproof
- Shock resistant
- Bi-directional readings
- Sturdy, hand-held, self-powered unit
- Visual and audible confirmation of readings
- No recharging station necessary
- Programmable language set
- Alphanumeric names possible

TECHNICAL DATA:

Memory Capacity: Up to 12,000 readings
Time Resolution: 1 minute
Data Transfer: Wireless, 300-19,200 Baud
Case Material: Polyester
Filling Media: Silicon for electronics and power pack
Power Supply: 4 x 1.5V alkaline batteries
Temperature: -22° to +176°F (-30° to +80°C)
Dimensions: L 8.6" x W 2.3" x H 1.2" (L 220mm x W 60mm x H 31mm)

DATA STRIPS



Each strip carries a mechanically imposed NRZI code that is read via magnetic response. The mechanical coding ensures that data can only be corrupted by physical destruction of the strip itself.

Data Strip Features:

- 100 million code variations possible
- Inexpensive
- Unobtrusive
- Quick and easy to mount
- Manipulation and duplication free; no two data strips have the same code
- Color options

For extreme conditions we have designed the MEGASTRIP, a heavy-duty data strip that is safe against any attempt at destruction. It is useful in areas where vandalism to data strips is to be expected (prisons) or where protection against acids or other hazardous material is required.

TECHNICAL DATA:

Material: Polyester
Data: 8 numeric digits plus check digit for 100 million variations
Code: Non-erasable mechanically imposed NRZI
Humidity: Resistant against humidity and water
Temperature: -22° to +176°F (-30° to +80°C)
Dimensions: L 3.5" x W 0.8" x H 0.1" (L 90mm x W 20mm x H 3mm)

DATA TRANSFER UNIT



Transfers from the DAU to a printer or personal computer through wireless transmission.

Data Transfer Unit Features:

- Serial or parallel version
- Connects to almost any printer
- Free of operation keys

TECHNICAL DATA:

Output: CCITT V.24/RS-232
Connector: 9-pin track (serial); 36-pin track (parallel)
Transfer Speed: 300-19,200 Baud
Power Consumption: 30 mA/9V
Dimensions: L 5.11" x W 2.6" x H 0.9" (L 130mm x W 68mm x H 25mm)
Weight: Approx. 5.7 oz. (200g)



DETEX CORPORATION

302 Detex Drive
New Braunfels, Texas 78130 USA
PH: (830) 629-2900
(800) 729-3839
FAX: (830) 620-6711
<http://www.detex.com>

New York Office
170 Broadway, 10th Floor
New York, NY 10038
PH: (212) 732-6450
FAX: (212) 233-0269